



**CONSTRUCTION ALERT**  
**September 16, 2016**

**CONTACT:** Tommy Williamson  
(817) 914-0543  
[twilliamson@ferrovial.us](mailto:twilliamson@ferrovial.us)

**FULL DIRECT CONNECTOR AND INTERCHANGE CLOSURES SCHEDULED  
AT I-820/I-35W THIS WEEKEND**

**FORT WORTH, Texas** – Motorists should expect full direct connector and interchange closures at I-820/I-35W this weekend. A complete list of closures and traffic redirections is as follows:

Friday, September 16, 9 p.m. to 10 a.m.

- All lanes of eastbound I-820 at the I-35W/I-820 interchange will be closed. Traffic will be redirected along the frontage road to Meacham Boulevard.
- The direct connector from southbound I-35W to eastbound I-820 will be closed. Traffic will be redirected to Meacham Boulevard.

Saturday, September 17, 9 p.m. to 10 a.m.

- All lanes of eastbound I-820 at the I-35W/I-820 interchange will be closed. Traffic will be redirected along the frontage road to Meacham Boulevard.
- The direct connector from southbound I-35W to eastbound I-820 will be closed. Traffic will be redirected to Meacham Boulevard.

This work is weather-permitting. **Updated closure information is posted daily** on Twitter ([@NTExpress](https://twitter.com/NTExpress)) and Facebook ([facebook.com/northtarrantexpress](https://facebook.com/northtarrantexpress)).

This work is part of the \$1.4 billion North Tarrant Express 35W project. This includes a section that is currently ranked number six on the state's most congested roadway list along 6.5 miles of I-35W from north of I-30 to north of I-820 including the I-35W/I-820 interchange in Fort Worth. The project includes the reconstruction of main lanes and the addition of TEXpress managed lanes.

Drivers are encouraged to "Know Before They Go," and visit [www.northtarrantexpress.com](http://www.northtarrantexpress.com) for upcoming closures. To view detour maps, please visit the [Alternate Route Map](#) page of our website. Also, as our lane closures are updated frequently, please visit the [Lane Closures](#) page on our website daily for the most current information. Closures are subject to weather conditions, and construction activities may be postponed if necessary.

###

## EASTBOUND I-820 CLOSURES AT I-35W/I-820 INTERCHANGE

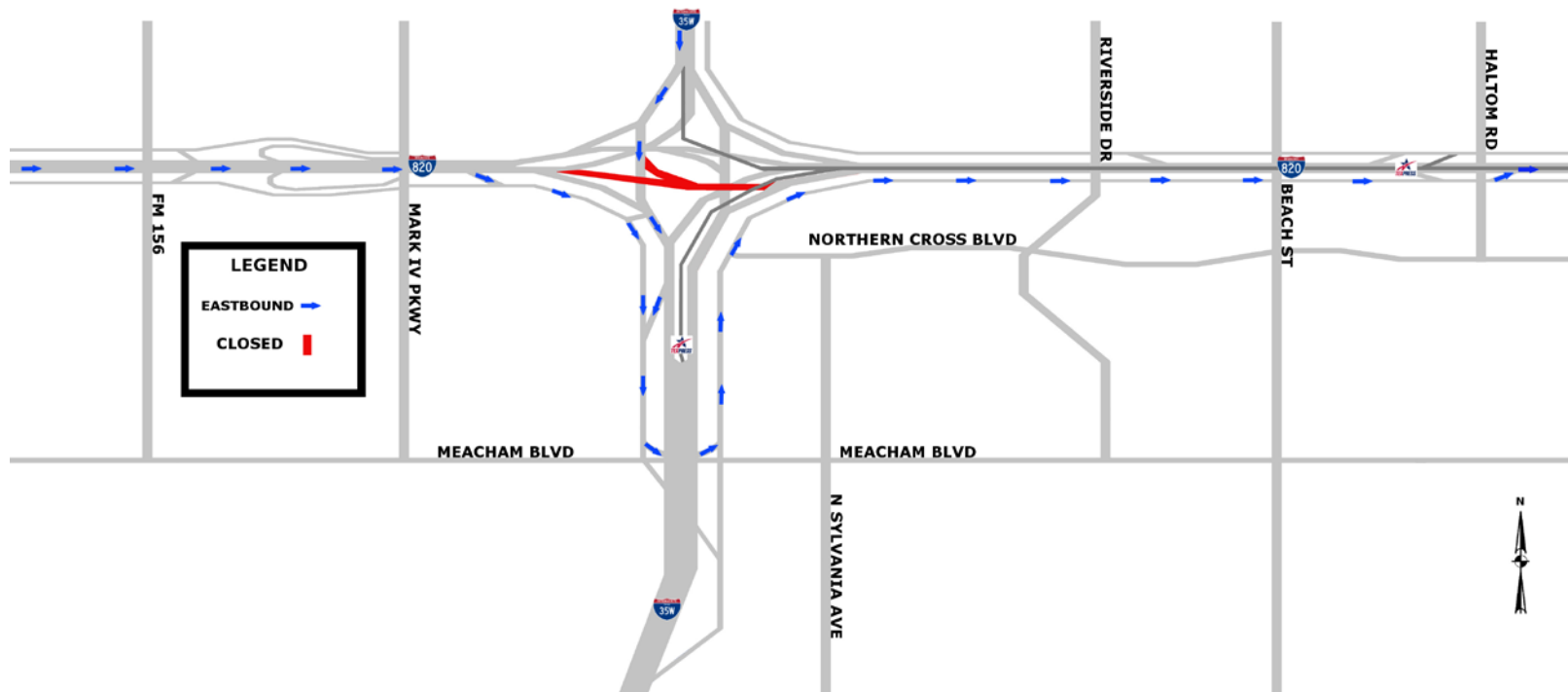

All lanes of eastbound IH 820 at the I-35W/IH 820 interchange will be closed.  
Traffic will be redirected along the frontage road to Meacham Blvd.

The direct connector from southbound I-35W to eastbound IH 820 will be closed.  
Traffic will be redirected to Meacham Blvd.