



CONSTRUCTION ALERT
February 25, 2016

CONTACT: Tommy Williamson
(817) 914-0543
twilliamson@ferrovial.us

SPUR 280 DEMOLITION TO OCCUR FEBRUARY 26 THROUGH 28

FORT WORTH, Texas – This weekend, **February 26 through February 28**, there will be a demolition of the remaining infrastructure of Spur 280 over I-35W. Drivers can expect the following closures:

Friday, February 26 at 9 p.m. through Saturday, February 27 at noon:

- Northbound and southbound I-35W will be reduced to one lane each direction at Spur 280.
- The direct connector from eastbound I-30 to northbound I-35W will be closed. Traffic will be redirected to Rosedale St.
- The direct connectors from southbound I-35W to eastbound and westbound I-30 will be closed. Traffic will be redirected to Rosedale St.

Saturday, February 27 at 9 p.m. through Sunday, February 28 at noon:

- Northbound and southbound I-35W will be reduced to one lane each direction at Spur 280.
- The direct connector from eastbound I-30 to northbound I-35W will be closed. Traffic will be redirected to Rosedale St.

This work is part of the \$1.4 billion North Tarrant Express 35W project. This includes a section that is currently ranked number six on the state's most congested roadway list along 6.5 miles of I-35W from north of I-30 to north of I-820 including the I-35W/I-820 interchange in Fort Worth. The project includes the reconstruction of main lanes and the addition of TExpress managed lanes.

Drivers are encouraged to "Know Before They Go," and visit www.northtarrantexpress.com for upcoming closures. To view detour maps, please visit the [Alternate Route Map](#) page of our website. Also, as our lane closures are updated frequently, please visit the [Lane Closures](#) page on our website daily for the most current information. Closures are subject to weather conditions, and construction activities may be postponed if necessary.

###

ALTERNATE ROUTE MAP FOR COWTOWN MARATHON DUE TO 35W CONSTRUCTION

Friday, February 26 to Sunday, February 28 9 p.m. to noon (nightly)



There will be various major construction activities on northbound and southbound I-35W at Spur 280. Cowtown Marathon participants should seek an alternate route.

Suggested alternate routes for people on northbound I-35W are Loop 820 to I-30.
Suggested alternate routes for people on southbound I-35W are Loop 820 to I-30 or Loop 820 to SH 121.

DIRECT CONNECTOR CLOSURES AT THE I-35W/I-30 INTERCHANGE

Friday, February 26 at 9 p.m. to 12 p.m. Saturday, February 27

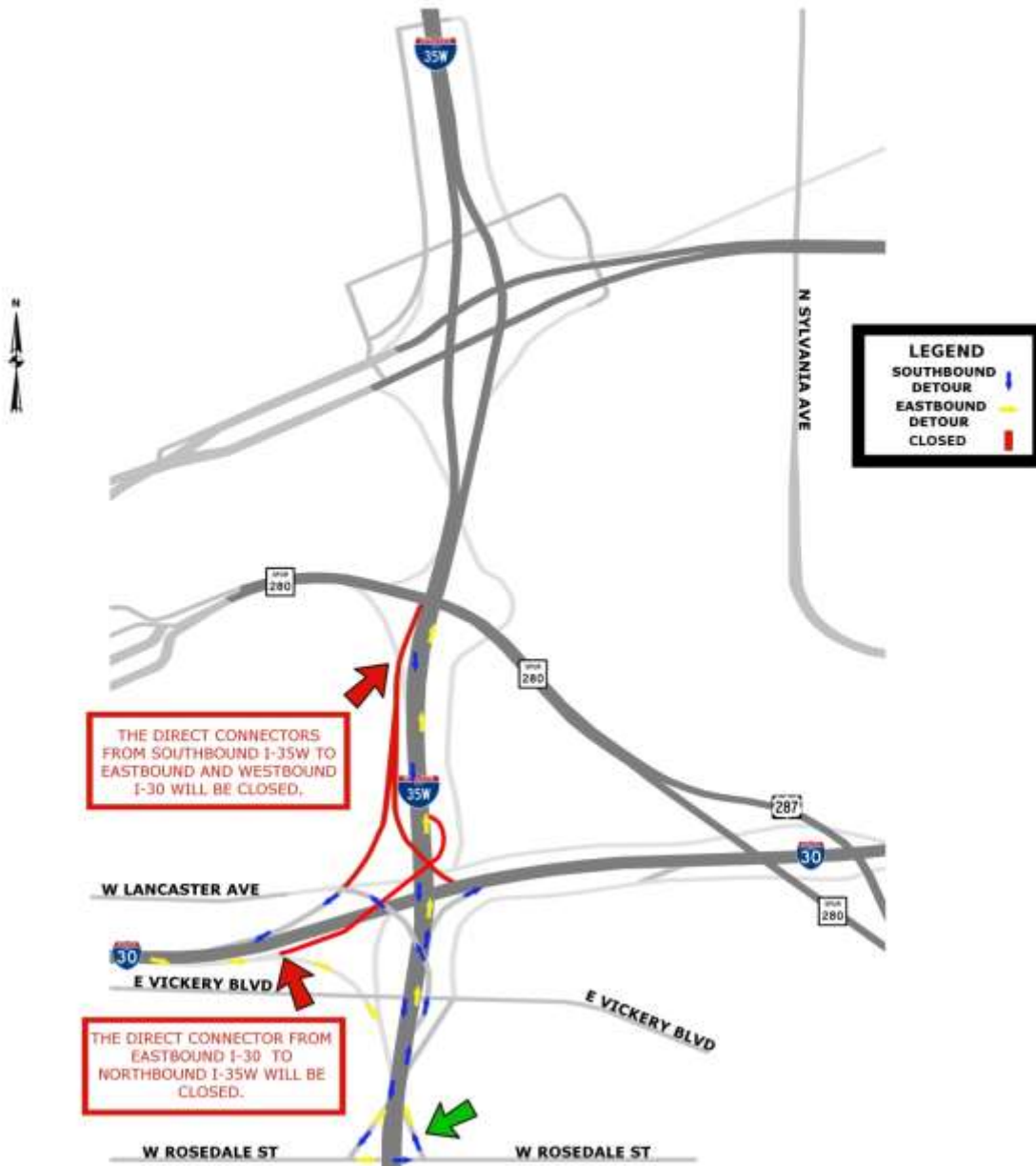

The direct connectors from southbound I-35W to eastbound and westbound I-30 will be closed.

The direct connector from eastbound I-30 to northbound I-35W will also be closed.

Traffic will be redirected to Rosedale St.

CLOSURE OF THE DIRECT CONNECTOR FROM EASTBOUND I-30 TO NORTHBOUND I-35W

Saturday, February 27 at 9 p.m. to 12 p.m. Sunday, February 28



The direct connector from eastbound I-30 to northbound I-35W will be closed.

Traffic will be redirected to Rosedale St.