



CONSTRUCTION ALERT
February 25, 2016

CONTACT: Tommy Williamson
(817) 914-0543
twilliamson@ferrovial.us

OVERNIGHT CLOSURES ON I-35W BEGINNING FEBRUARY 26

FORT WORTH, Texas – The following closures will go into effect beginning **Friday, February 26:**

Friday, February 26 through Saturday, February 27, overnight from 9 p.m. to 10 a.m.:

- The direct connector from northbound I-35W and westbound IH 820. Traffic will be redirected to Basswood Boulevard.
- The direct connector from eastbound IH 820 to northbound I-35W. Traffic will be redirected to Haltom Road.
- Northbound and southbound I-35W at Spur 280 will be reduced to one lane each direction.
- The direct connectors from southbound I-35W to eastbound and westbound I-30. Traffic will be redirected to Rosedale Street.
- The on-ramp to the eastbound IH 820 TEXpress lanes from northbound I-35W. Traffic will be redirected to the next entrance at Riverside Dr. from the eastbound IH 820 general purpose lanes.
- The direct connector from eastbound I-30 to northbound I-35W. Traffic will be redirected to Rosedale Street.

Saturday, February 27 through Sunday, February 28, overnight from 9 p.m. to 10 a.m.:

- The direct connector from northbound I-35W westbound IH 820. Traffic will be redirected to Basswood Boulevard.
- The direct connector from eastbound IH 820 to northbound I-35W. Traffic will be redirected to Haltom Road.
- Northbound and southbound I-35W at Spur 280 will be reduced to one lane each direction.
- The on-ramp to the eastbound IH 820 TEXpress lanes from northbound I-35W. Traffic will be redirected to the next entrance at Riverside Dr. from the eastbound IH820 general purpose lanes.
- The direct connector from eastbound I-30 to northbound I-35W. Traffic will be redirected to Rosedale Street

Sunday, February 28 through Monday, February 29, overnight from 9 p.m. to 5 a.m.:

- The direct connector from eastbound IH 820 to northbound I-35W. Traffic will be redirected to Haltom Road.
- All lanes of southbound I-35W at the I-35W/IH 820 interchange. Traffic will be redirected to FM 156.
- The direct connector from southbound I-35W to eastbound IH 820. Traffic will also be redirected to FM 156.

This work is part of the \$1.4 billion North Tarrant Express 35W project. This includes a section that is currently ranked number six on the state's most congested roadway list along 6.5 miles of I-35W from north of I-30 to north of I-820 including the I-35W/I-820 interchange in Fort Worth. The project includes the reconstruction of main lanes and the addition of TEXpress managed lanes.

Drivers are encouraged to "Know Before They Go," and visit www.northtarrantexpress.com for upcoming closures. To view detour maps, please visit the [Alternate Route Map](#) page of our website. Also, as our lane closures are updated frequently, please visit the [Lane Closures](#) page on our website daily for the most current information. Closures are subject to weather conditions, and construction activities may be postponed if necessary.

###

DIRECT CONNECTOR CLOSURES AT THE I-35W/I-30 INTERCHANGE

Friday, February 26 at 9 p.m. to 12 p.m. Saturday, February 27

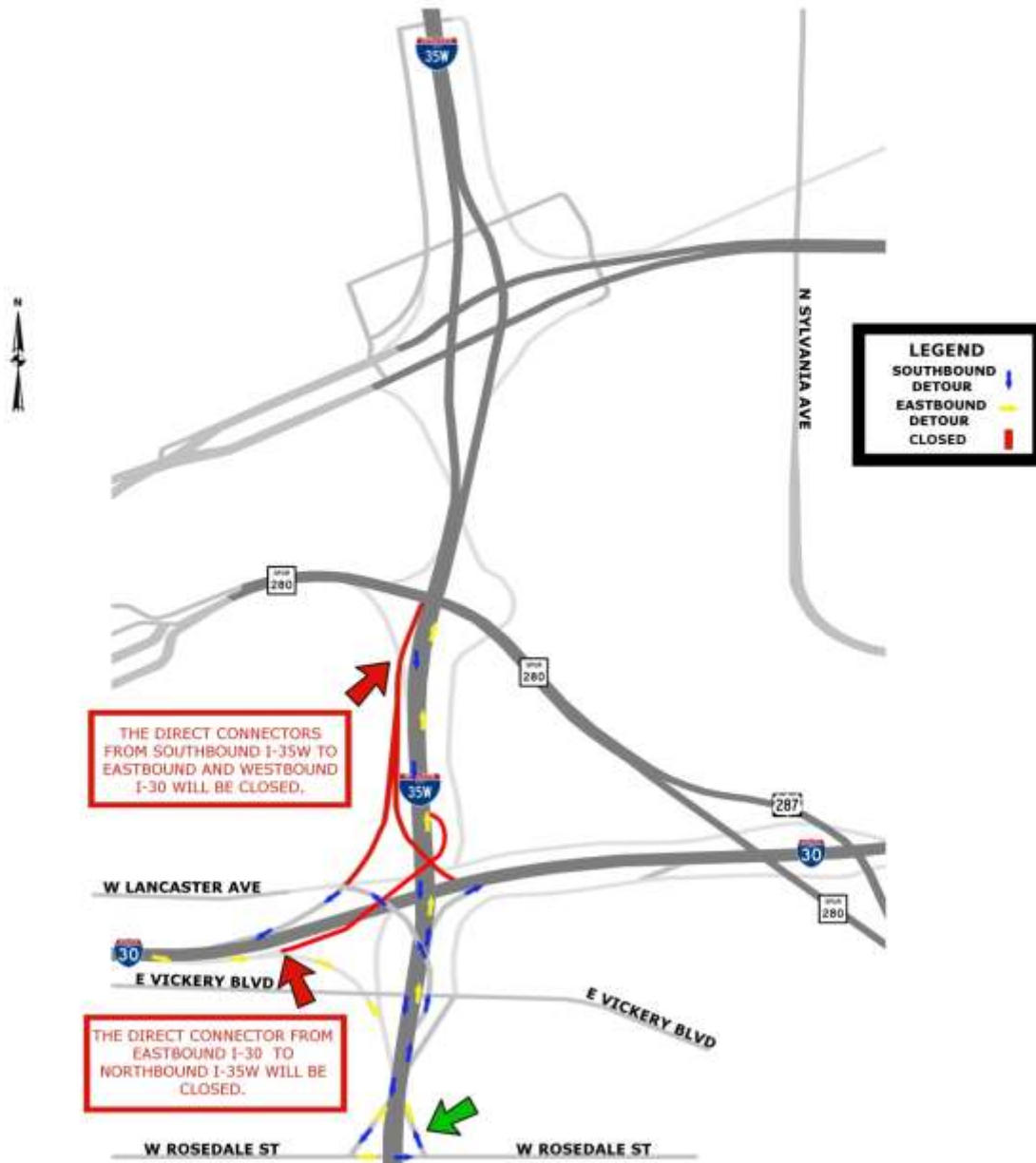

The direct connectors from southbound I-35W to eastbound and westbound I-30 will be closed.

The direct connector from eastbound I-30 to northbound I-35W will also be closed.

Traffic will be redirected to Rosedale St.

CLOSURES AT THE I-35W/I-820 INTERCHANGE

Friday, February 26 to Sunday, February 28 from 9 p.m. to 10 a.m. (nightly)



The direct connector from northbound I-35W to westbound I-820 will be closed.
Traffic will be redirected to Basswood Blvd.

The direct connector from eastbound I-820 to northbound I-35W will be closed.
Traffic will be redirected to Haltom Rd.

CLOSURE OF THE DIRECT CONNECTOR FROM EASTBOUND I-30 TO NORTHBOUND I-35W

Saturday, February 27 at 9 p.m. to 12 p.m. Sunday, February 28



The direct connector from eastbound I-30 to northbound I-35W will be closed.

Traffic will be redirected to Rosedale St.

SOUTHBOUND I-35W CLOSURES AT THE I-35W/I-820 INTERCHANGE

Sunday, February 28 from 9 p.m. to 5 a.m. Monday, February 29



All lanes of southbound I-35W at the I-35W/I-820 interchange will be closed.

The direct connector from southbound I-35W to eastbound I-820 will also be closed.

Traffic will be redirected to FM 156.