



CONSTRUCTION ALERT
March 3, 2016

CONTACT: Tommy Williamson
(817) 914-0543
twilliamson@ferrovial.us

MAJOR CLOSURES AT I-35W/I-820 INTERCHANGE OVERNIGHT ON MAR. 3

FORT WORTH, Texas – Drivers can expect delays due to major closures at the I-35W/I-820 interchange overnight on **Thursday, March 3**. The closures are as follows:

Thursday, March 3 at 9 p.m. to Friday, March 4 at 5 a.m.:

- All lanes of eastbound and westbound I-820 at the I-35W/I-820 interchange. Eastbound I-820 traffic will be redirected to Meacham Blvd., and westbound I-820 traffic will be redirected to Basswood Blvd.
- The direct connector from southbound I-35W to eastbound I-820. Traffic will be redirected to Meacham Blvd.
- The direct connector from northbound I-35W to westbound I-820. Traffic will be redirected to Basswood Blvd.

This work is part of the \$1.4 billion North Tarrant Express 35W project. This includes a section that is currently ranked number six on the state's most congested roadway list along 6.5 miles of I-35W from north of I-30 to north of I-820 including the I-35W/I-820 interchange in Fort Worth. The project includes the reconstruction of main lanes and the addition of TEXpress managed lanes.

Drivers are encouraged to "Know Before They Go," and visit www.northtarrantexpress.com for upcoming closures. To view detour maps, please visit the [Alternate Route Map](#) page of our website. Also, as our lane closures are updated frequently, please visit the [Lane Closures](#) page on our website daily for the most current information. Closures are subject to weather conditions, and construction activities may be postponed if necessary.

###

WESTBOUND I-820 CLOSURES AT THE I-35W/I-820 INTERCHANGE

Thursday, March 3 from 9 p.m. to 5 a.m. Friday, March 4



All lanes of westbound I-820 at the I-35W/I-820 interchange will be closed.

The direct connector from northbound I-35W to westbound I-820 will be closed.

Traffic will be redirected to Basswood Blvd.

CLOSURES AT I-35W /IH 820 INTERCHANGE

Thursday, March 3 at 9 p.m. to 5 a.m. Friday, March 4

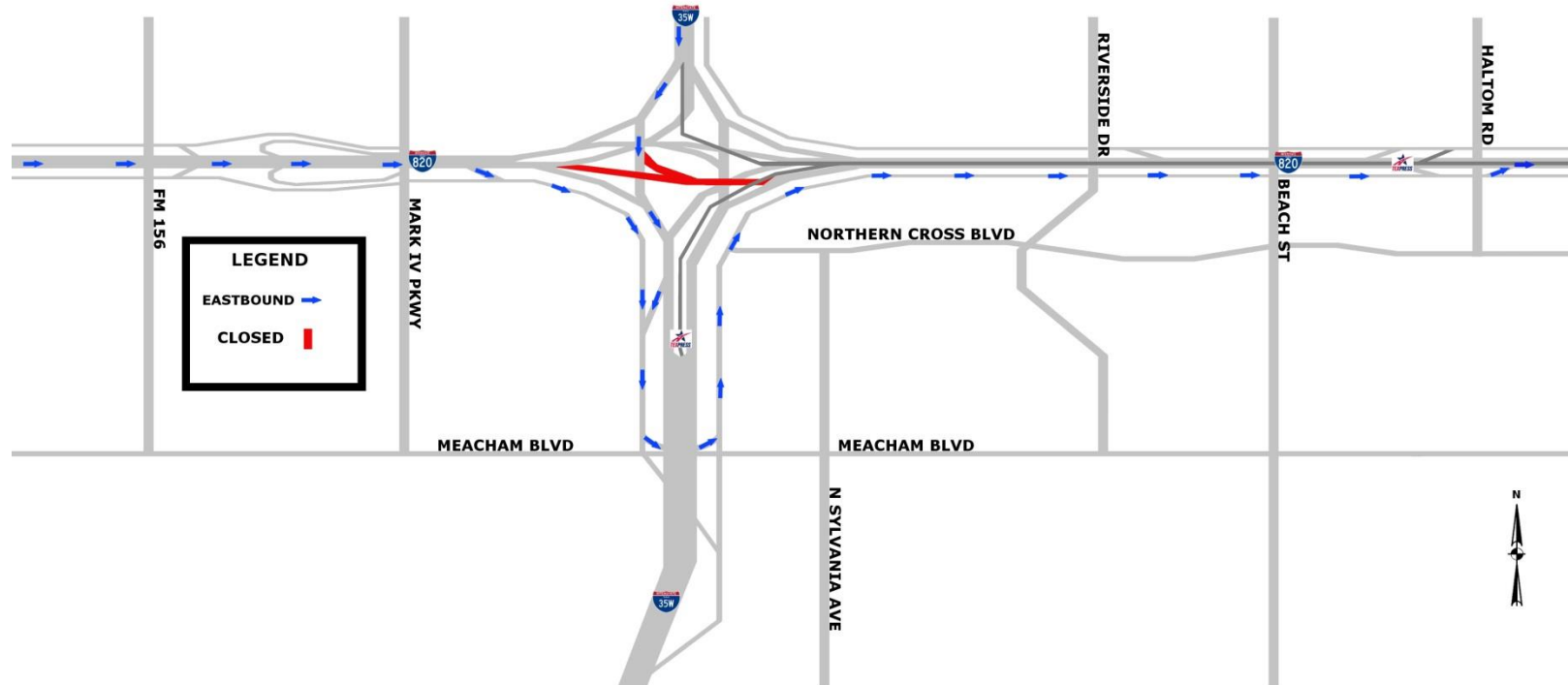

All lanes of eastbound IH 820 at the I-35W/IH 820 interchange will be closed.
Traffic will be redirected along the frontage road to Meacham Blvd.

The direct connector from southbound I-35W to eastbound IH 820 will be closed.
Traffic will be redirected to Meacham Blvd.