



CONSTRUCTION ALERT
December 8, 2017

CONTACT: Tommy Williamson
(817) 914-0543
twilliamson@ferrovial.us

MAJOR CLOSURES ON I-35W FROM I-820 TO I-30 DECEMBER 8-10

FORT WORTH, Texas – On **Friday, December 8th from 9 p.m. to 10 a.m. Saturday, December 9th** the following closures will be in place:

- Rolling full freeway closures southbound I-35W from Western Center Blvd. to Northern Cross Blvd.
- Rolling full freeway closures on southbound I-35W from Meacham Blvd. to NE 33rd St.

On **Saturday, December 9th from 9 p.m. to 10 a.m. Sunday, December 10th** the following closures will be in place:

- Rolling closures on the off-ramp from northbound I-35W to Northside Dr.
- Rolling closures on the on-ramp to southbound I-35W from Northside Dr.

On **Sunday, December 10th from 4 a.m. to 9 p.m.** the following closures will be in place:

- All lanes of southbound I-35W at Meacham Blvd. will be closed. Traffic will be redirected along the frontage road.
- All lanes of eastbound and westbound Meacham Blvd. at I-35W will be closed. Eastbound traffic will be redirected to NE 28th St. and westbound traffic to Western Center Blvd.
- The direct connectors from eastbound and westbound I-820 to southbound I-35W will be closed. Traffic will be redirected to Western Center Blvd.
- All lanes of the southbound I-35W frontage road at Great Southwest Pkwy. will be closed. Traffic will be redirected to Mark IV Pkwy.

On **Sunday, December 10th from 9 p.m. to 5 a.m. Monday, December 11th** the following closures will be in place:

- The direct connector from southbound I-35W to westbound I-820 will be closed. Traffic will be redirected to Denton Hwy. 377.
- Rolling closures on the direct connector from northbound I-35W to westbound I-820.

- Rolling full freeway closures on northbound I-35W from Luella St. to Spur 280.

This work is weather-permitting. **Updated closure information is posted daily** on Twitter ([@NTExpress](#)) and Facebook (facebook.com/northtarrantexpress).

This work is part of the \$1.4 billion North Tarrant Express 35W project, which includes a 6.5-mile section that is currently ranked 23rd on the state's most congested roadways list. Ranked sixth when construction began in 2013, this section of I-35W from north of I-30 to north of I-820 including the I-35W/I-820 interchange in Fort Worth is already seeing traffic improvements with the reconstruction of main lanes and the addition of TEXpress Lanes.

Drivers are encouraged to "Know Before They Go," and visit www.northtarrantexpress.com for upcoming closures. To view detour maps, please visit the [Alternate Route Map](#) page. Also, as lane closures are updated frequently, please visit the [Lane Closures](#) page daily for the most current information. Closures are subject to weather conditions, and construction activities may be postponed if necessary.

###

CLOSURES ON SOUTHBOUND I-35W AT MEACHAM BLVD

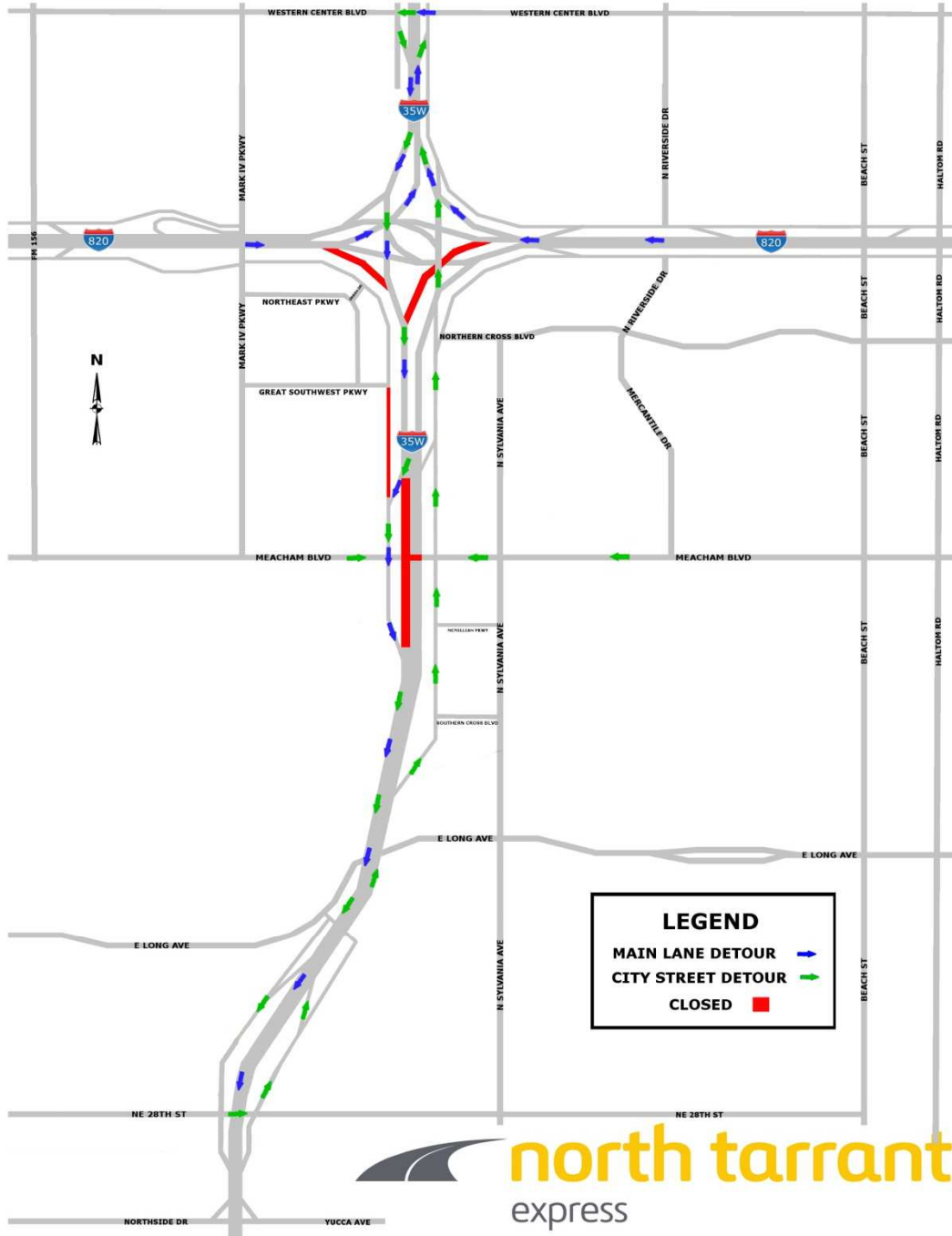

The direct connectors from eastbound and westbound I-820 to southbound I-35W will be closed. Traffic will be redirected to Western Center Blvd.

All lanes of the southbound I-35W frontage road from Great Southwest Pkwy. to the southbound I-35W off-ramp to Meacham Blvd. will be closed. Traffic will be redirected to Mark IV Pkwy.

All lanes of eastbound and westbound Meacham Blvd. at I-35W will be closed. Eastbound traffic will be redirected to NE 28th St. and westbound traffic to Western Center Blvd.

All lanes of southbound I-35W at the Meacham Blvd. off-ramp will be closed. Traffic will be redirected along the frontage road.